

# CIP Project Updates

December 2024





# Snow Hill



## Current Status

- Design and engineering for boat and kayak launches are under Critical Area Commission review. Full Commission review scheduled for Jan. 2025.
- Design and engineering of the entrance and park road improvements have begun.
- Playground and Pavilion constructed.
- Old sidewalks, pavilion, bocce court and retaining wall demolished.
- Waterfront hammock Grove



## Improvements Coming

- Boat Launch and trailer parking on Patuxent River
- Kayak Launch and Parking on Roslin Creek
- Sight line clearing and retaining wall at park entrance





# Hammock Grove



# Shannon Farm



## Current Status

- Master approval to Commissioners - January 31, 2023
- Design and engineering final plans complete and sent to NAVY and County for review and permits.
- Under Critical Area Commission Review



## Improvements coming

- Boardwalk and pathway from to beach
- Parking lot
- ADA Beach Access
- Restrooms
- Playgrounds



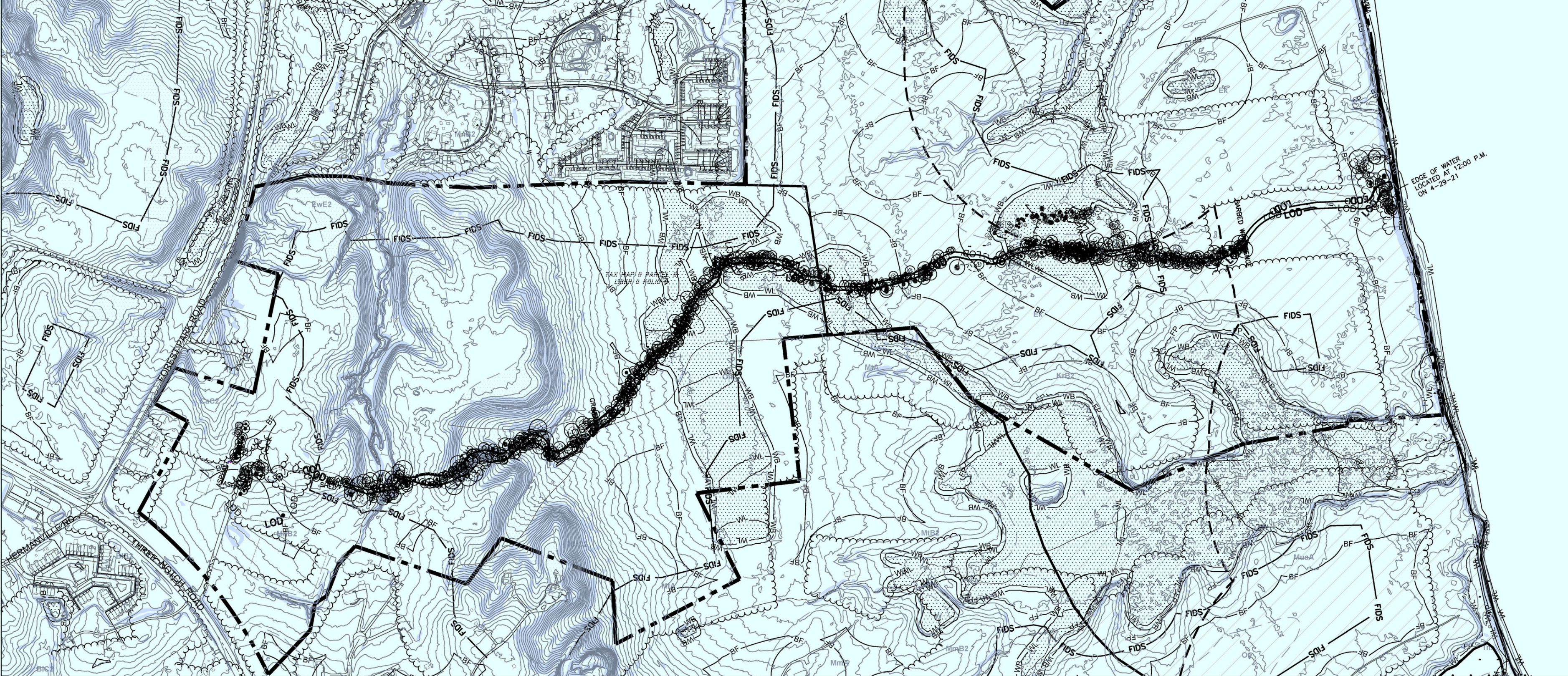

**SITE LEGEND**

|  |                     |  |                            |  |                           |
|--|---------------------|--|----------------------------|--|---------------------------|
|  | PROPERTY BOUNDARIES |  | 1000' CRITICAL AREA        |  | SOIL                      |
|  | LDD                 |  | RESOURCE CONSERVATION AREA |  | HIGHLY ERODILE SOILS      |
|  | 100                 |  | LIMITED DEVELOPMENT AREA   |  | STEEP SLOPES 15% AND OVER |
|  | 101                 |  | TIDAL WETLAND              |  |                           |
|  | FP                  |  | NON-TIDAL WETLAND          |  |                           |
|  | WL                  |  |                            |  |                           |
|  | BF                  |  |                            |  |                           |
|  | FIDS                |  |                            |  |                           |
|  | EDGE OF EX. FOREST  |  |                            |  |                           |

**Professional Certification.** I hereby certify that these documents were prepared or approved by me, and that I am a duly licensed professional engineer under the laws of the State of Maryland.

License No. 37683

Expiration Date 07/13/2025  
Philip D. Rhodes, P.E.





# Elms Beach

- Approval to move forward received from the Department of Natural Resources to move forward on Architecture and engineering (A&E) for Master Plan.
- Bid awarded January 2023 for design
- Perc test applications submitted for new bathroom facilities.
- Design under Critical Area Commission Review.





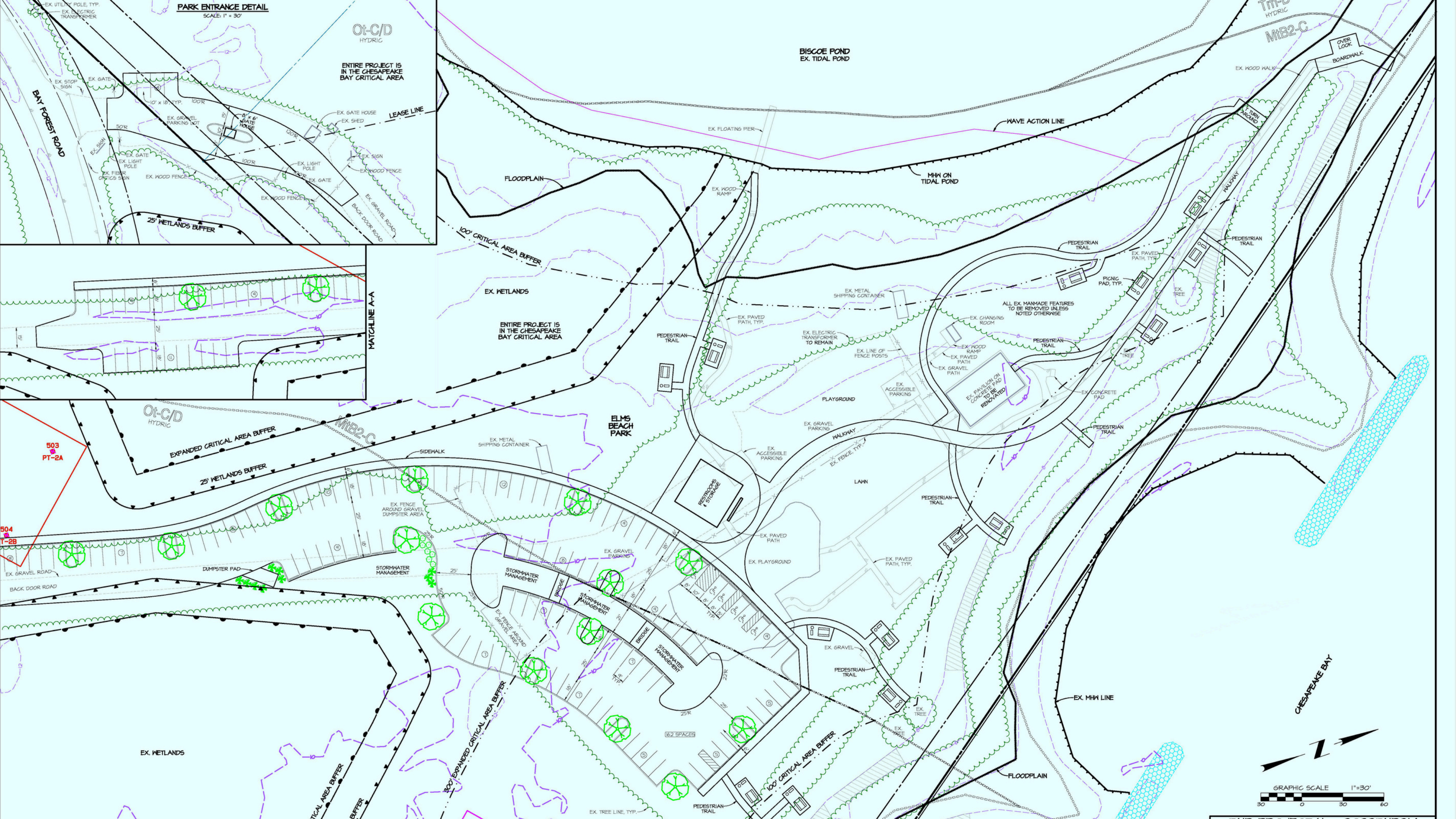

PARK ENTRANCE DETAIL  
SCALE: 1" = 30'

Ot-C/D  
HYDRIC

ENTIRE PROJECT IS  
IN THE CHESAPEAKE  
BAY CRITICAL AREA

BISCOE POND  
EX. TIDAL POND

TM-B  
HYDRIC

MtB2-C

OVER  
LOOK

BOARDWALK

WAVE ACTION LINE

MHW ON  
TIDAL POND

FLOODPLAIN

100' CRITICAL AREA BUFFER

ENTIRE PROJECT IS  
IN THE CHESAPEAKE  
BAY CRITICAL AREA

EXPANDED CRITICAL AREA BUFFER

25' WETLANDS BUFFER

MtB2-C

ELMS  
BEACH  
PARK

EX. METAL  
SHIPPING CONTAINER

RESTROOMS  
STORAGE

LAWN

PEDESTRIAN  
TRAIL

EX. GRAVEL

EX. MHW LINE

FLOODPLAIN

CHESAPEAKE BAY



GRAPHIC SCALE 1"=30'  
30 0 30 60



# Myrtle Point

Award for Design and Engineering was made to Maginniss and del Ninno Architects in December 2023.

- Kick off meeting held January 2024.
- Preliminary Design in progress.







VISION WORKSHOP ANALYSIS

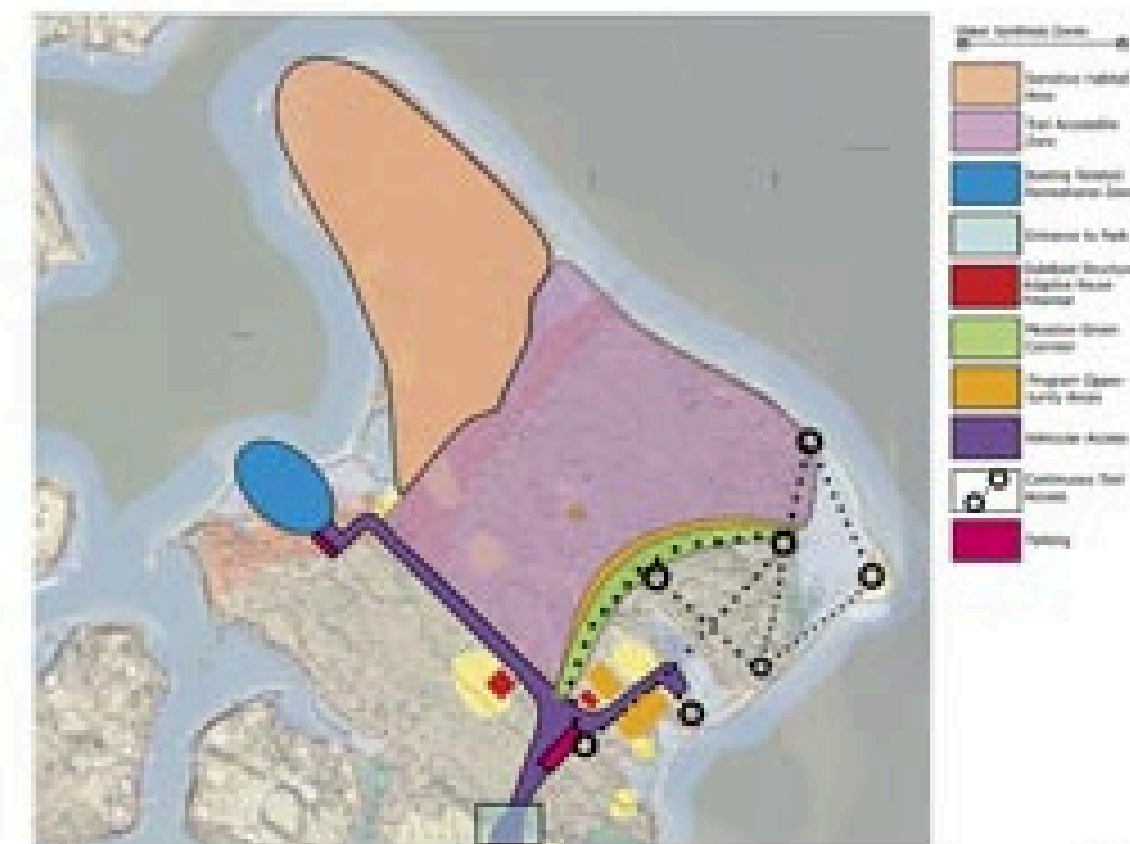

VISION WORKSHOP SYNTHESIS



# Three Notch Trail Phase VII

- Working with businesses and organizations for Right of Way Support
- Final Engineered drawings and comment responses returned to the County December 2024





# Skate Parks

## Spring 2025 Construction



**Chaptico**

- Final Designs and Stormwater Management Plans submitted to permitting December 2024.



**Nicolet**

- Final Designs and Stormwater Management Plans expected submission to Permitting December 2024.
- Renovations to current park will begin in Jan. 2025



