



Renovation Project

Leonard Hall Recreation Center

Presented by
St. Mary's County
Recreation & Parks

Date:
March 20, 2023



Timeline

April 1

Demolition

- Remove Flooring & Dasher Boards
- Remove Piping from Ceiling
- Remove Arcade Games
- Relocate Vending Machines to Lobby

Late April

Repairs & Prep

- Abatement
- Concrete Patching

Mid May

Installation

- VersaCourt Floor Tiles
- Dasher Boards
- Retractable Bleachers
- Upgraded sound system

Mid June

Reopening

Leonard Hall Recreation Center Renovation Project



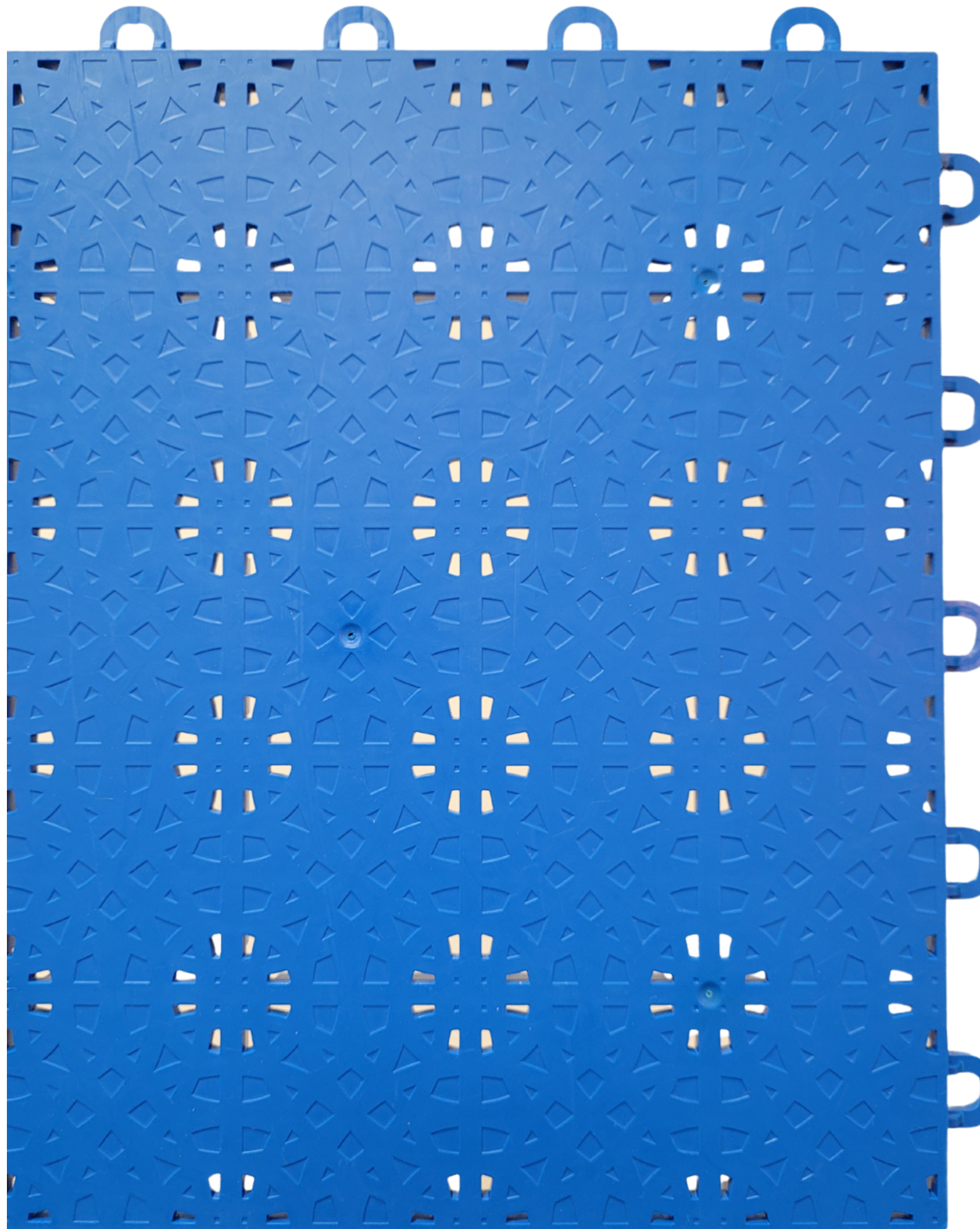

Floor Tiles and Lines:

VersaCourt Interlocking Tiles

13,200 sq. ft. indoor tiles with noise deadening rubber vapor barrier underlayment.

Lines will be colored tiles (red, white, titanium) - no more painting wearing off



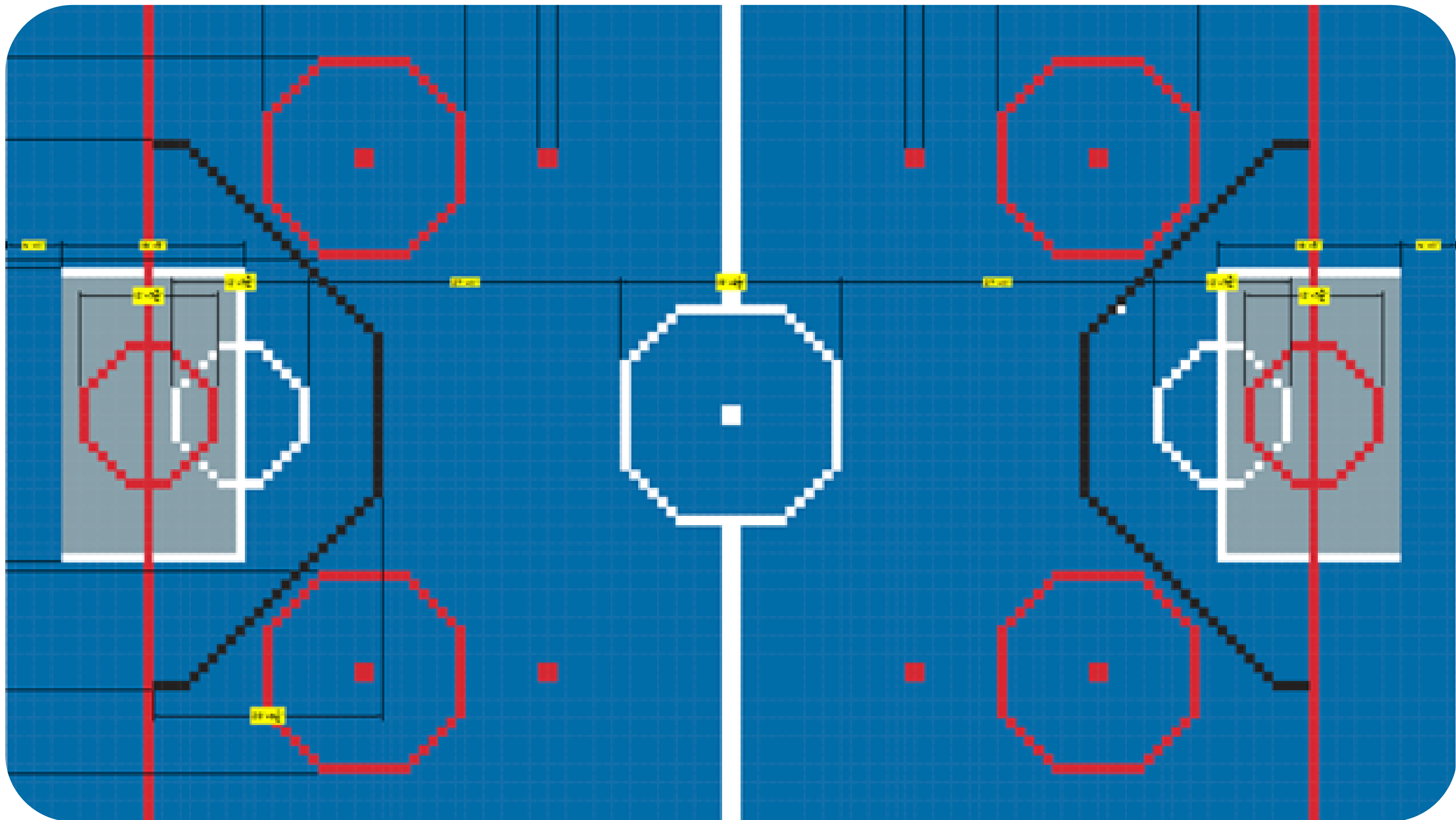



Dasher Boards

Infinity Series board system made of tempered aluminum dasher panels.

Two (2) indoor soccer goals with netting that retract at each end.

Three (3) access player gates.

One (1) 120' double-leaf equipment gate.

12' high nylon netting lining perimeter.

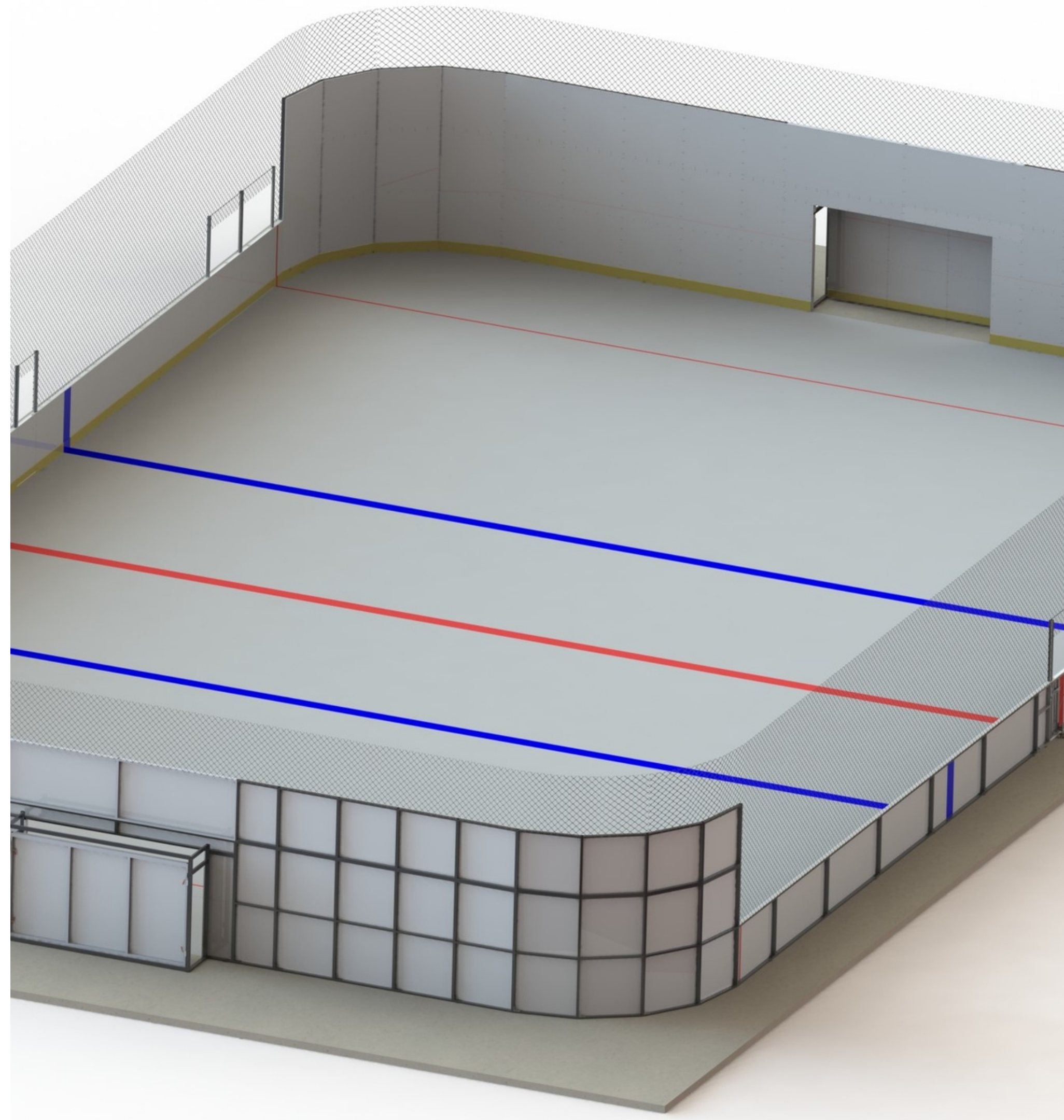

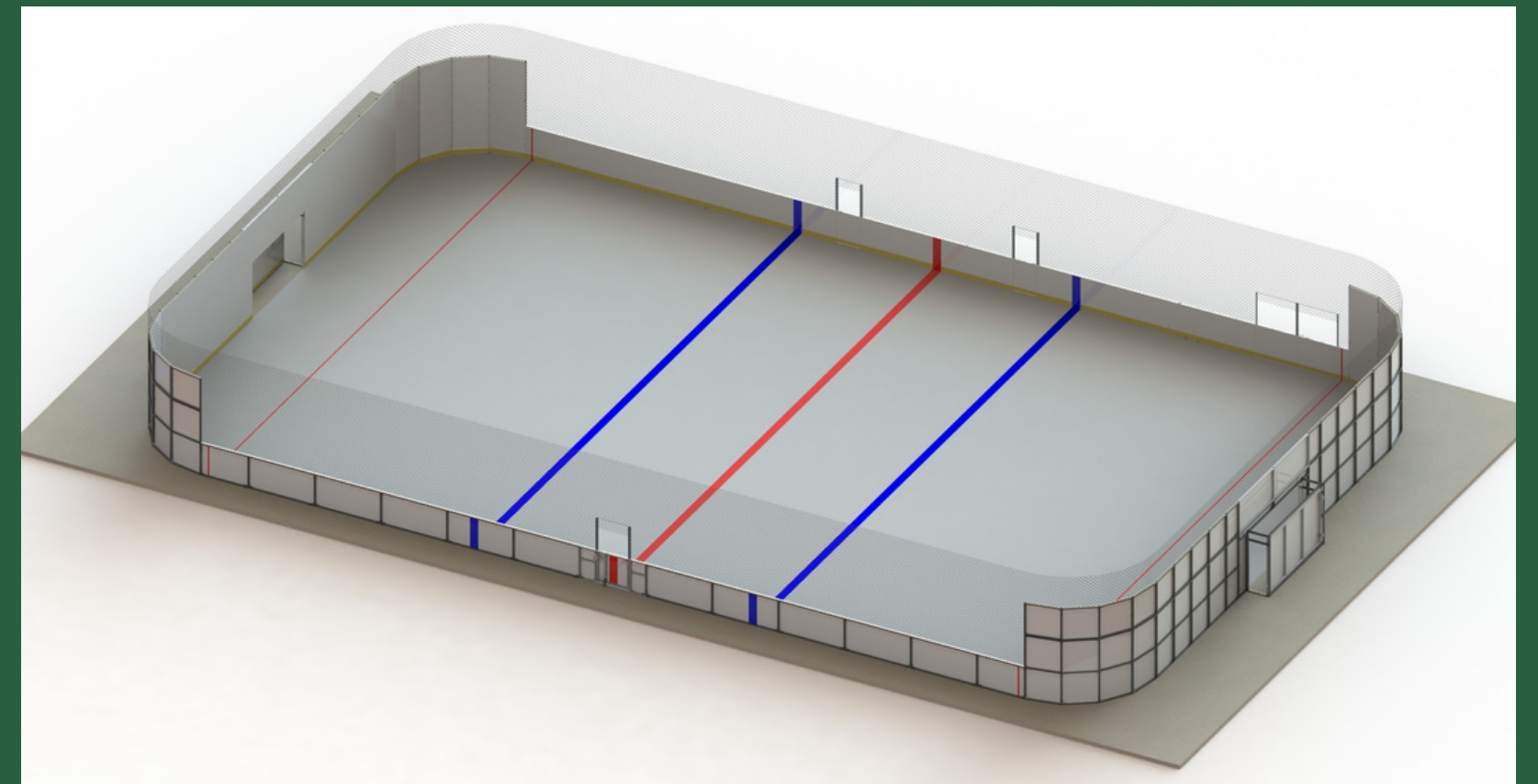
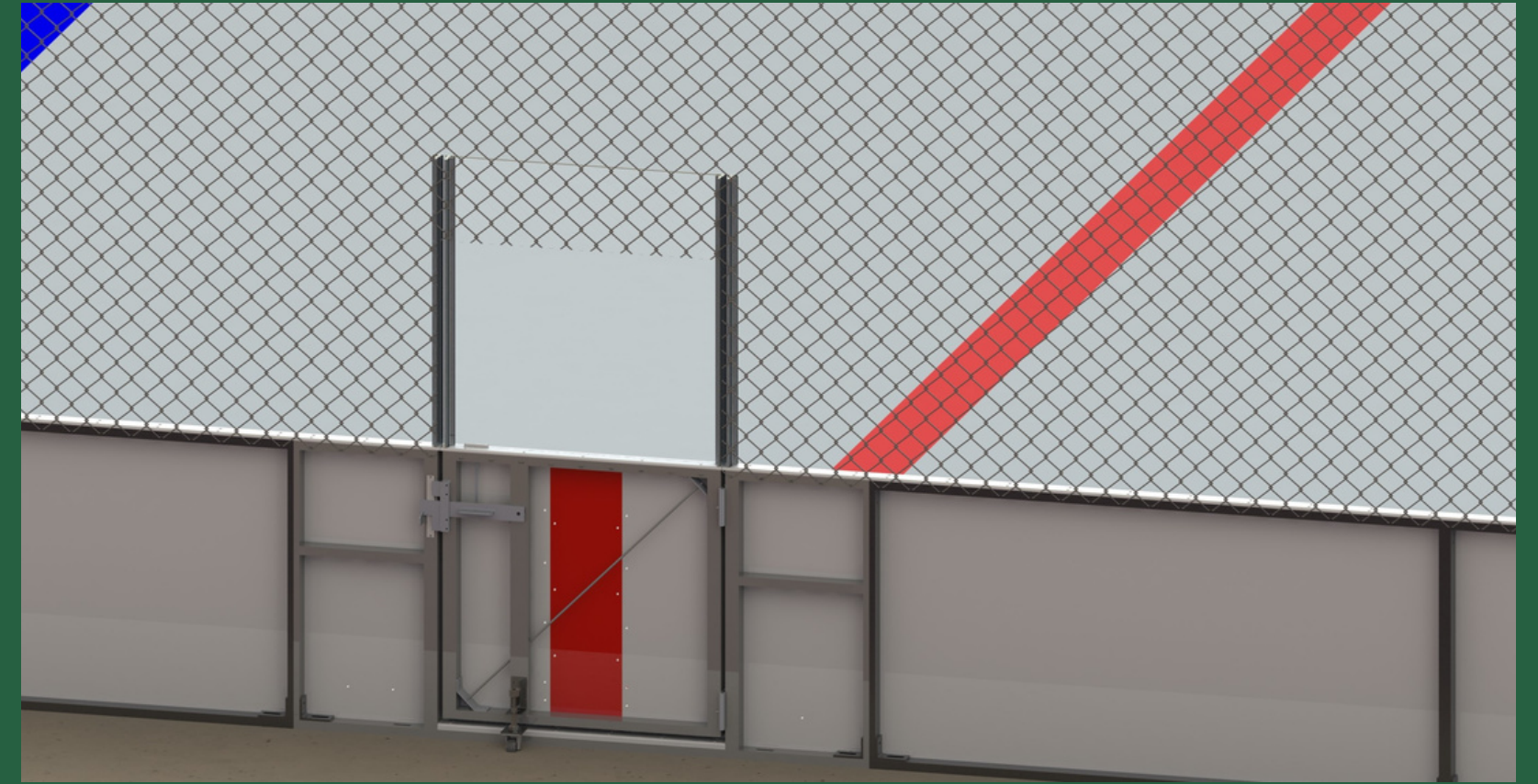
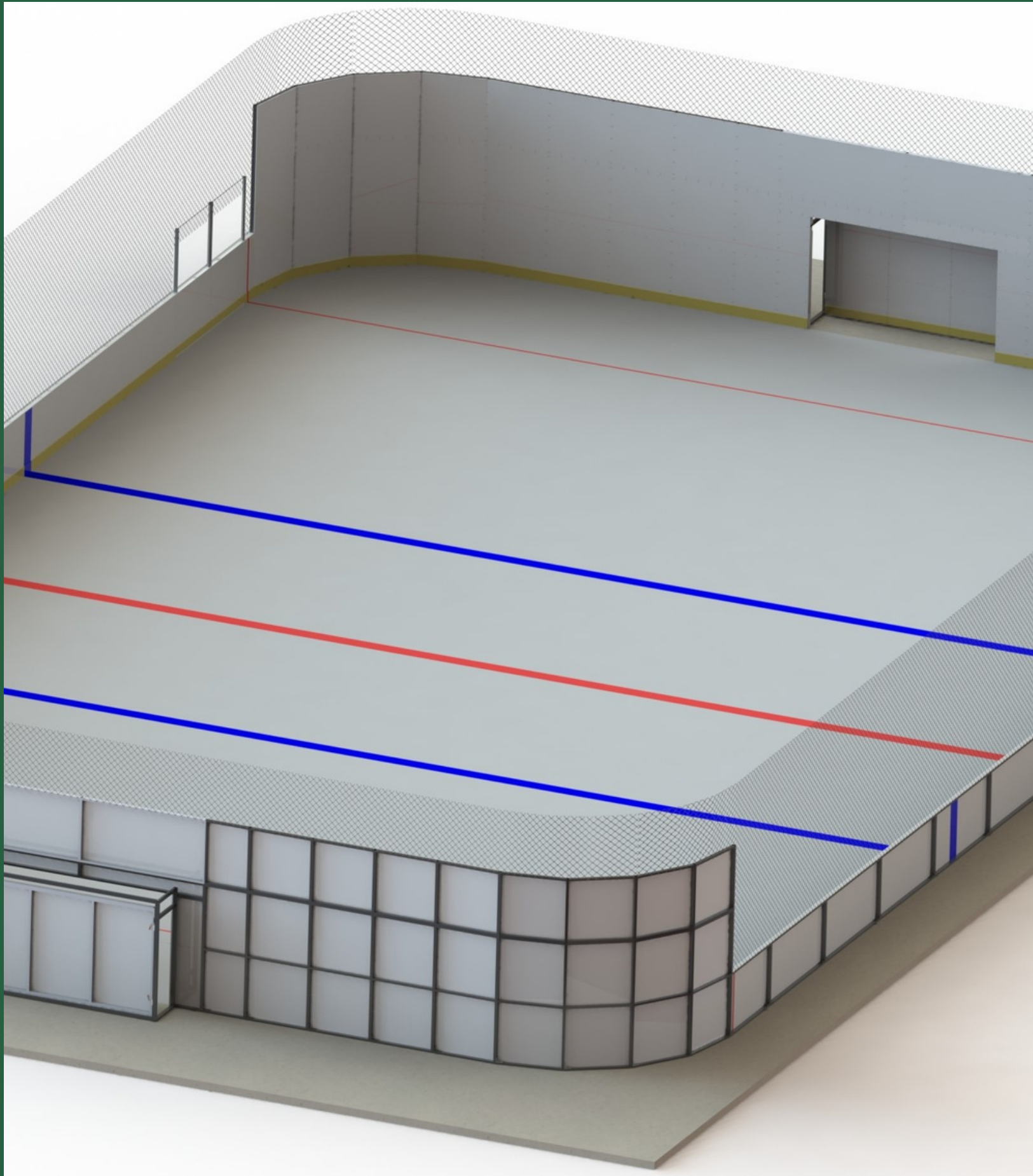

Dasher Board Components

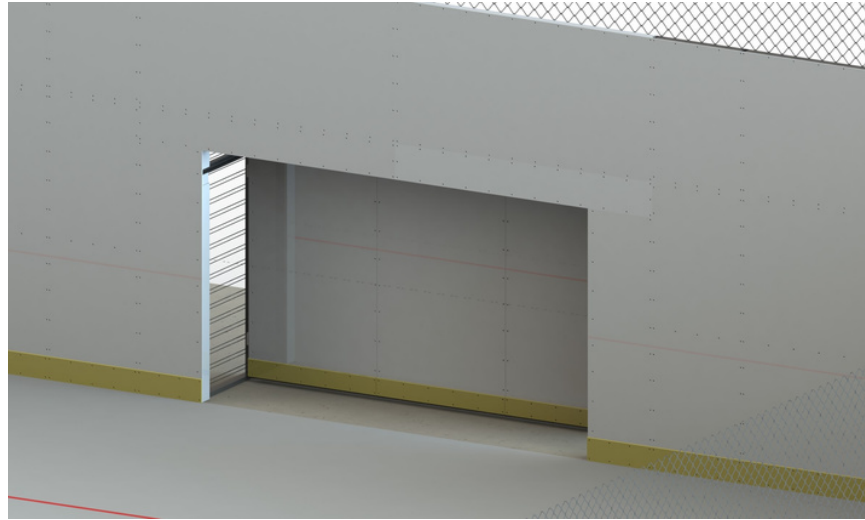

RETRACTABLE GOALS

Accessibility

Provide transition with ease and netting included.

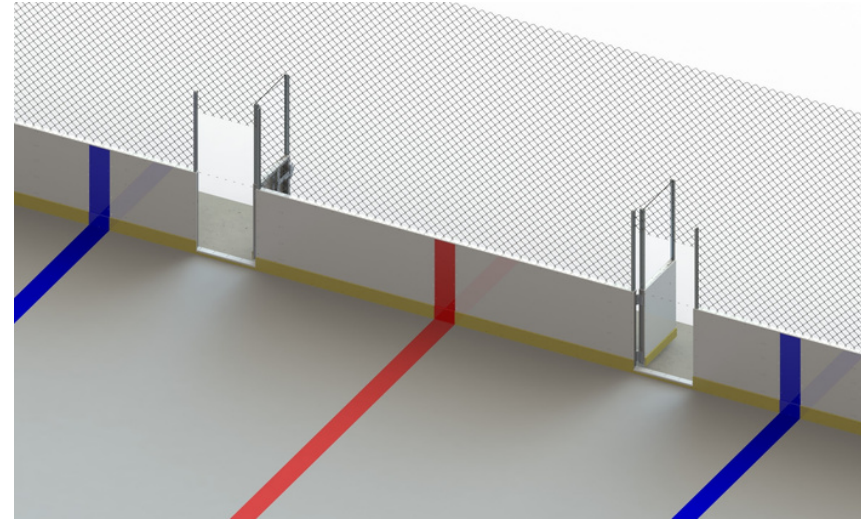

ACCESS GATES

Players

Positioned on either side of mid-field, gates will provide access for each to designated bench areas.

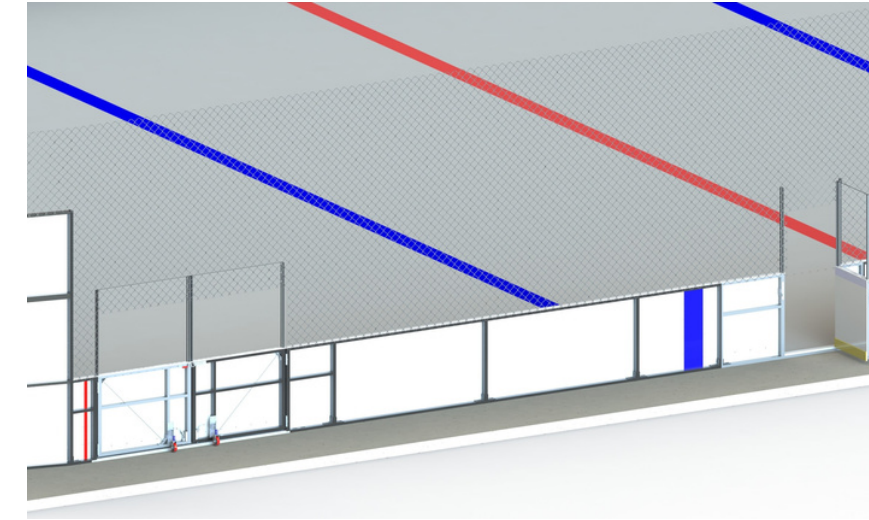

EQUIPMENT GATE

Improve Mobility

120' Equipment Gate allows for access for sport transition. Includes a collapsible equipment cart and a pair of hockey goals.





Bleachers

Telescopic seating available capable of accommodating up to 84 spectators. ADA compliant seats will be available.

Bleachers will be situated on the left hand-side wall when you walk into the arena.



Open areas will now be available to the right leading to the skate window providing safe and easier access for all users.

Highlights



Flooring

Multipurpose surface conducive for roller sports and indoor soccer.

Dasher Boards & Goals

Ideal for a variety of sports with ability to absorb impact.

High Netting

Manages reflective noise and safety for spectators and players.

Seating

Bleachers accessible for all spectators.

Sound System

Upgraded sound for announcements, music and events.

Improved Space

Modern design will create additional space for participants & spectators.



Best Guess

TOTAL TILES?
COURT TILES?
RED TILES?

BLACK TILES?
WHITE TILES?
TITANIUM TILES?

Answers



By the Tiles

There are a total of 19,591 tiles for the new floor.

11,099 blue for the court, 520 red, 132 black, 412 white, and 976 titanium.

An additional 6,452 tiles will cover the perimeter.

LEONARD HALL RECREATION CENTER RENOVATIONS

**SPORTS ARENA
CLOSED 4.01-6.22.23**

RENOVATION INCLUDES NEW:

VERSACOURT FLOORING

DASHER BOARDS

RETRACTABLE GOALS

RETRACTABLE BLEACHERS

UPGRADED SOUND SYSTEM

*Follow
-US-* → → →

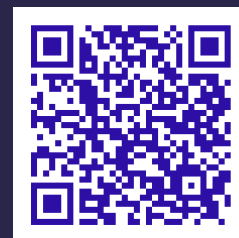

stmaryscountymd.gov/recreate

Project approved by Commissioners of St. Mary's County and funded
by Maryland Program Open Space

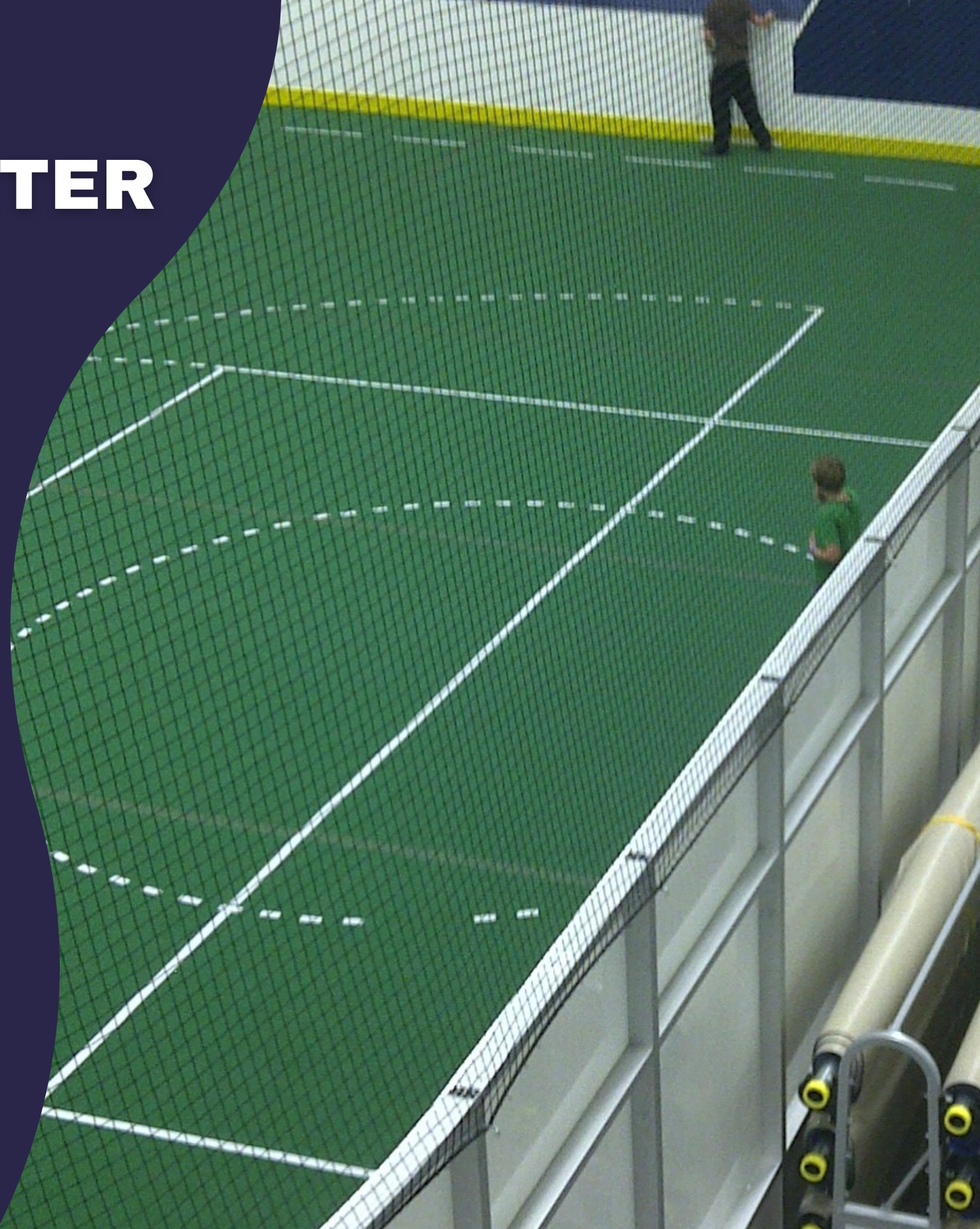



Questions?

St. Mary's County Recreation & Parks is eager for an improved space for all indoor activities. We appreciate your participation and support and look forward to welcoming you back this June!

stmaryscountymd.gov/recreate

webtrac@stmaryscountymd.gov

301-475-4200 ext. 1800